

Overview

Cable pulley 90 H with universal clamp 50 x 50 - PU = 20 pcs

Product number: 25250073

Options

PU (Pcs)

1

20

Version

H

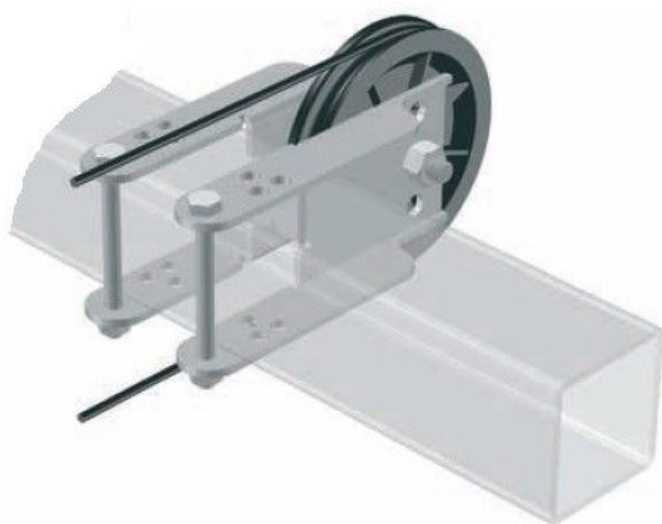

Description

This pulley can be attached to the backside of square tubes in shading systems. Its axle position can be adjusted at three different heights via three holes in the steel bracket.

Created at 19.05.2024.

* Our offers are directed exclusively to companies. We do not conclude contracts with consumers. All prices excl. VAT plus shipping costs and possible delivery charges, if not stated otherwise.



Fiberlane LLC - 9254
Richmond Road - 18013
Bangor, PA

Tel.: +1 610 498 447 4
Fax.: +1 610 498 2602

email:
info(at)fiberlanellc.com

The pulley can be used for cables with a diameter up to 7 mm
Suits the following square tubes: 50 x 50, 50 x 55, 50 x 30, 50 x 25, 50 x 20 mm

Material:

Pulley: High impact resistant plastic

Bracket: Galvanized steel