

## Overview

# Cable pulley 100 UF - with universal clamp 50 x 50

**Product number:** 25250070-1

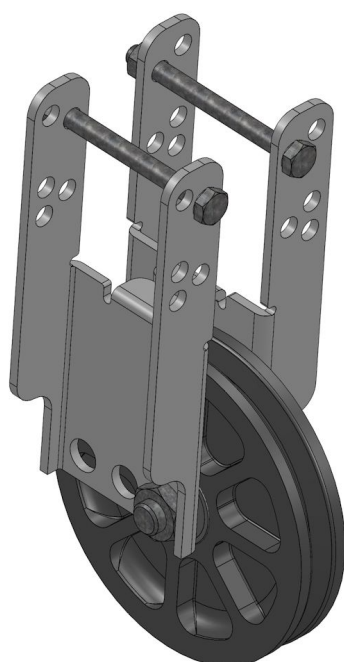

## Options

### PU (Pcs)

1

20

25

### Version

H

UF

## Description

This pulley can be attached to the backside of square tubes in shading systems. Its axle position can be adjusted at three different heights via three holes in the steel bracket.

The pulley can be used for cables with a diameter up to 3 mm  
Suits the following square tubes: 60 x 60

Created at 20.05.2024.

\* Our offers are directed exclusively to companies. We do not conclude contracts with consumers. All prices excl. VAT plus shipping costs and possible delivery charges, if not stated otherwise.



Fiberlane LLC - 9254  
Richmond Road - 18013  
Bangor, PA

Tel.: +1 610 498 447 4  
Fax.: +1 610 498 2602

email:  
info(at)fiberlanellc.com

Material:

Pulley: high impact resistant plastic

Bracket: Galvanized steel